

# F-911 VTS User Manual



# F-911 VTS English Manual

Thank you for purchasing the F-911 VTS motorcycle camera. This manual will go over how to properly use the device and provide you with detailed product information regarding operation, precautions, and technical data. Please read this manual carefully.

## Disclaimer

1. The F-911 VTS motorcycle camera is provided as is and the recording videos are only for reference; the final determination is subject to police investigation.
2. The company reserves the right to revise this manual at any time without prior notice. You may find the latest version from our website: <https://www.lookingtaiwan.com/en/product-support/handbook-download>.

## Important Notices

1. Don't expose this device to alcohol, oils, or other chemicals to prevent damage to the waterproof structure.
2. This device is water-resistant, but avoid direct contact with high-pressure water jets.
3. The product comes with different rubber mounts for front & rear recording. Please find the suitable rubber mount to secure the device tightly before riding.

## Warranty Policy

1. The main unit is covered by a 1-year warranty.
2. Other accessories and consumables are covered by a 3-month warranty.
3. Issues caused by human error are not covered under warranty.
4. The warranty period starts from the date of purchase.

## Precautions

1. Keep this product away from alcohol, grease, and other chemicals to avoid damaging the device structure.
2. The device is rated IP66 waterproof. However, avoid spraying it directly with high-pressure water.
3. When using a memory card for the first time, it must be formatted through the device to ensure the integrity of recorded video files.

4. It is recommended to format the memory card once a month to optimize storage performance.
5. Please use a memory card with a minimum writing speed of 30MB/s or higher.
6. All memory cards have a limited lifespan (based on read/write cycles). After prolonged use, performance may degrade, resulting in file reading/writing errors. If such issues occur, we recommend purchasing a new memory card.

## Product Structure

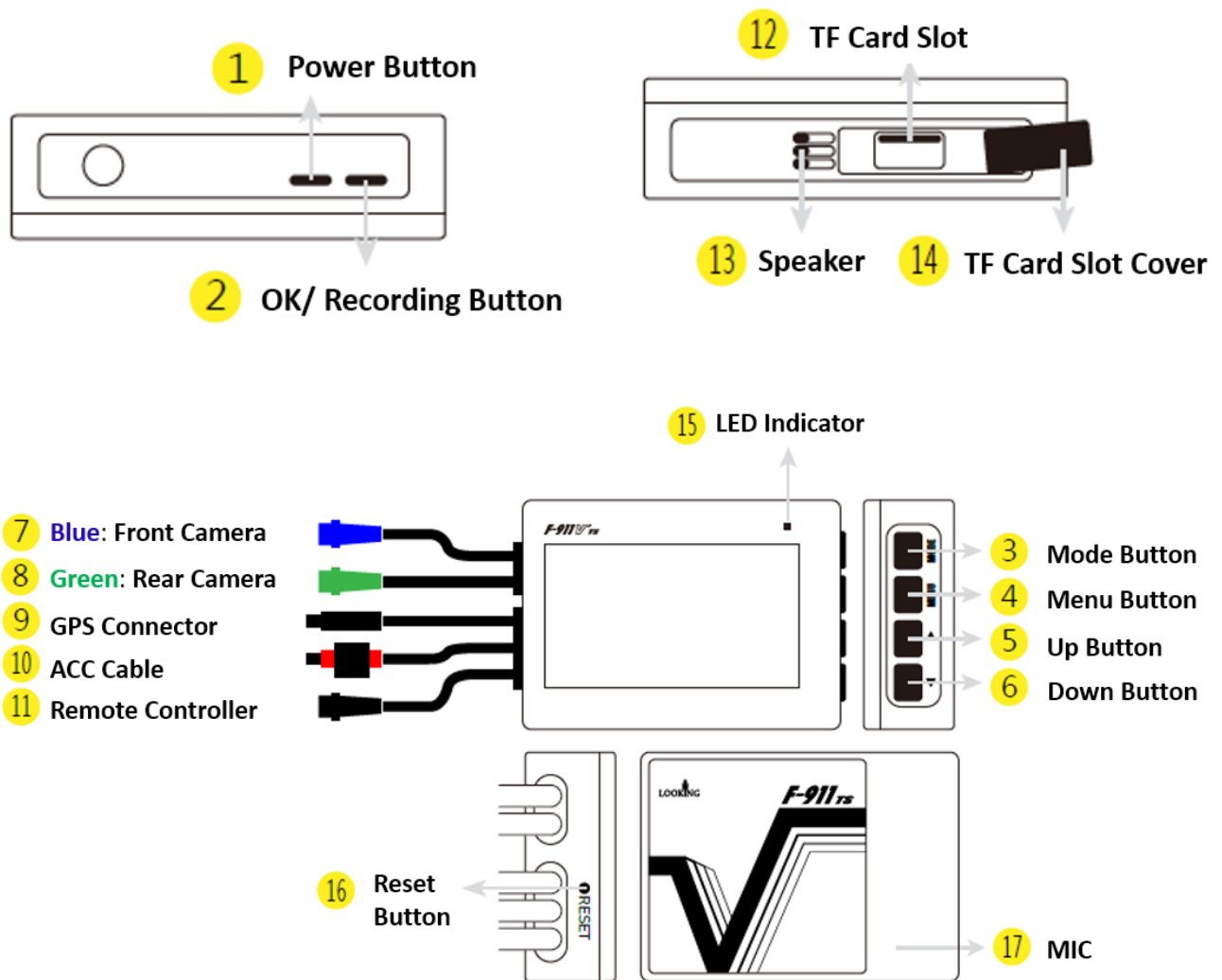

## Button Function Description

<b>Power Button ①</b>	<b>Long press</b> 3 seconds for power on/off
<b>OK / Rec. Button ②</b>	<b>Short press:</b> <ul style="list-style-type: none"><li>■ In video mode, press to start/stop recording</li><li>■ In photo mode, press to take pictures</li><li>■ In playback mode, press to start/stop playback</li><li>■ In the menu settings, press to enter selected menu or confirm</li></ul>
<b>Mode Button ③</b>	With recording paused, short press to switch mode of video recording, photo snapshot, or both files playback
<b>Menu Button ④</b>	With recording paused, short press to enter the settings menu
<b>Up Button ⑤</b>	<b>Short press:</b> <ul style="list-style-type: none"><li>■ In video mode, press to turn on/off Wi-Fi</li><li>■ In the menu settings, press to move up through menu items</li></ul>
<b>Down Button ⑥</b>	<b>Short press:</b> <ul style="list-style-type: none"><li>■ In video mode, press to switch camera display (PIP, front or rear)</li><li>■ In the menu settings, press to move down through menu items</li></ul>

**Note: Pause recording and turn off Wi-Fi before using any function buttons on the device. Only then will the function buttons be activated.**

Step 1: Press Up Button ⑤ to turn off Wi-Fi

Step 2: Press Recording button ② to pause recording

## Optional 7-in-1 Wired Controller:

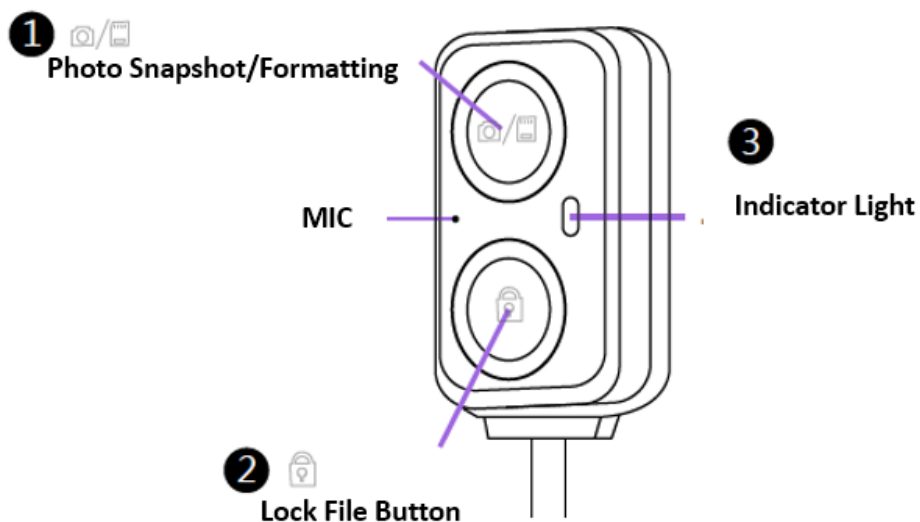

Functions		Indicator Light Status
1	Recording	● Flashing 1 time/sec
2	Stop recording	● Remains on
3	Snapshot	● Flashing 5 times
4	Lock critical file	● Flashing 2 time/sec until the file is saved
5	30 Days memory card format notification	● Flashing 1 time/sec
6	Memory card in formatting	● Red light quick flashing
7	Abnormality (memory card /Camera)	● Remains on
8	Updating firmware	● Flashes slow, then fast until the update is done

## Key Operation

### A. Turn on/off the device & Automatic Shutdown

1. Long press 3 seconds of Power Button **1** to turn on/ off the device.
2. In the menu settings, can set the automatic shutdown time of the host. If no operation or recording occurs within the setting time, the machine will shut down automatically.

### B. Recording Mode

1. Power on the device — recording will begin automatically. A recorder icon will appear in the upper-left corner, and a flashing red indicator confirms that recording is in progress.
2. While in recording mode, short press the recording button **2** to start or pause recording.

**Note: Do not remove the memory card during recording to prevent file corruption or card damage.**

### C. Photo Mode

1. Press the mode button **3** to enter photo mode. A camera icon will appear in the upper -left corner.
2. Press the OK button **2** to take a photo.

### D. Playback Mode

1. Press the mode button **3** to enter playback mode. A playback icon will appear in the upper-left corner.
2. Press the Up button **5** & Down button **6** to browse files.
3. Press the OK button **2** to playback the file
4. Short press the menu button **4** to access options like delete or protect files. Use the up button **5** or down button **6** to navigate and OK button **2** to confirm.

## General Settings

Press the Menu button **4** to enter the settings menu. Use the Up button **5** or Down button **6** to move through the menu options, and short press the OK button **2** to confirm.

Settings Menu Options:	
Resolution:	1920 x 1080P 30FPS
Photo Resolution:	2MP
Loop Recording:	Off / 3 minutes
Recording Sound:	Off / On
Tilt Lock:	Off / On
GPS Speed Mark:	Off / On
Date Recording:	Off / On
Date & Time Setup:	Use the Up button <b>5</b> or Down button <b>6</b> to adjust the time, then short press the OK button <b>2</b> to confirm and proceed to the next setting
Screen Saver:	Off / 1 minute / 3 minutes / 5 minutes / 10 minutes
Auto Shutdown:	Off / 3 minutes / 5 minutes / 10 minutes
Key Beep:	Off / On
Language:	Traditional Chinese / Simplified Chinese / English
Memory Card Format Reminder:	Off / 30 days / 45 days The system will prompt notice to manually format the memory card.
Memory Card Formatting:	Deletes all files on the memory card
System Restore:	Restores factory default settings
Version:	to view the current firmware version of the device

## Installation

1. Hidden installation of the display and lens.
2. Connect the red cable to ACC Key-on (+), and black to GND.
3. Please use the full set of the cable and machine, the car charger transforms the voltage from 12V-24V to 5V.
4. Adjust the lens angle when the installation is done.
5. The controller has built-in MIC, don't cover it when installation.

## Insert Micro SD card

1. Insert the Micro SD card according to the indicated direction
2. To remove the memory card, push the card in and the card should automatically pop out.
3. The process of formatting the memory card:

### By using the Device-

Short press the OK/ Recording Button ② to pause recording → Short press the Menu button ④ to enter the settings menu → Select "Memory Card Format" → Press the OK/ Recording Button ② to execute the format.

### By using the controller-

Long press Photo snapshot / Formatting button → Red light will start flashing → Short press Photo snapshot / Formatting button again → the red light will start Quick flashing until formatting complete.

### Note:

1. Please format the memory card when using a new card in this device for the first time.
2. Please use the U3 micro SD card. (30MB/S above)

## Pop Up Memory Card Format Notification

1. A notice to remind users to format the memory card. In the setting menu there are options for 30 or 45 days. Default setting is 30 days.
2. Reminder methods: (1) Camera display (2) Looking cam APP (3) Wired controller

**Note:** Format the memory card regularly to extend the lifespan of the card and ensure the camera is recording stably.

## Product Features

1. SONY Starvis + HDR sensor, no overexposure at night
2. TS technology to save the recording file every second
3. Equipped with a super capacitor, safer and more durable than traditional lithium batteries.
4. Pop up memory card format notification
5. Waterproof connectors, screwed to avoid any loose while riding
6. Supports Wi-Fi connection, allowing file access via mobile app without disassembly
7. With a 7-in-1 functions wired controller, supporting one-click photo capture and file lock, memory card formatting, recording indicator, automatic format reminder, microphone recording and abnormal warning.
8. Optional GPS to record speed and route

## WIFI APP

1. Scan the QR code to download the APP
2. Switch on the motorcycle DVR and WIFI function (the WIFI default setting is on)
3. The WIFI name & password will show on the display. Password: 12345678
4. After the device is linked, you may now use the APP

Note: When the device is on, the Wi-Fi is auto on. press Up button 5 to turn off the Wi-Fi before using the other buttons, press Up button 5 again to turn on the Wi-Fi.



Please scan the QR code to download the App,  
or search LOOKING CAM on Google play / App Store.



▶ iOS APP



▶ Android APP



## Product Specification

Lens	Front – SONY 307 Starvis Night Vision Rear –LOOKING Exclusive Optical Lens
Aperture	F /1.8
Monitor	2.7 ” LCD Display
Resolution	FHD1920 x 1080P 30 FPS
Viewing Field	Dual 150°
Video Format	TS
Photo Format	JPEG
Audio	Built-in MIC in the host External MIC in wired controller
Memory card	Max. 128G Micro SD (U3 writing speed 30MB/S above )
External Power supply	Input: 12V-24V 2A Output: 5V 2A
Internal Power supply	Supercapacitor
Host Dimension	76 x 55 x 22 mm / 108 g
Working humidity	10%-80%
Working Temperature	-10 °C ~ + 60 ° C
7-in-1 Wired Controller	Standard
GPS	Optional

## Problem Shooting

- Can't record: Check the SD card if there is enough space.
- Stop recording while riding: (1) Check the SD card if it is with 30MB/S above. The SD card writing & reading speed is required to this device. (2) Check the loop recording is on or not.
- "Wrong file" or "damaged file" showed: Check the SD card and format it (please use the device to format the SD card not by PC). If the SD card has problem the file can't be saved properly.
- Fuzzy image: Check the camera lens and clean it.
- The image is shaking: (1) Check the lens bracket is fixed tightly. (2) Check the installation of the device, if it's too closed to the coil and spark plug, it will have signal interference.
- Buttons no work: Turn off the WIFI first, if the WIFI function is on, the buttons can't work.

If you need any further assistance, please email to [sales@lookingtaiwan.com](mailto:sales@lookingtaiwan.com)

THANK YOU!